

Unpacking Your Furniture

When your furniture is shipped for curbside delivery, it is packed in numerous layers to protect it during transport. It is essential that you unpack the goods carefully so you do not accidentally damage the furniture whilst unpacking. Below are the layers you can expect to find, as well as advice on the best way of removing them.

1. Timber crates

The outer layer of packaging is a timber crate. If the crate is secured with screws, first remove the screws with a screwdriver.

If secured with nails, use a crowbar or the crow end of a hammer to release the sides of the crate. Remove the furniture from the side. **BEWARE** of the protruding nails once the crate has been opened.

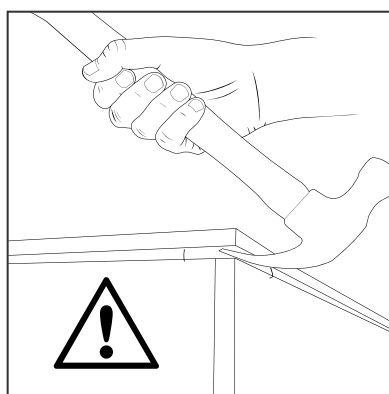
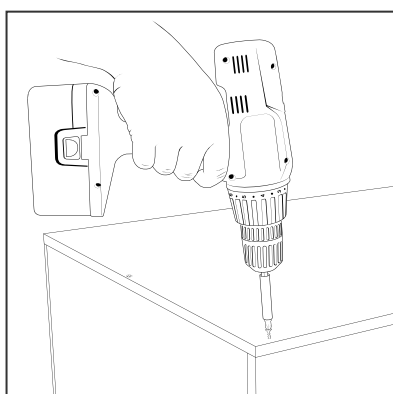

2. Cardboard

The next layer is cardboard. This is sealed with layers of packing tape. To remove the cardboard, use a sharp cutting knife to lightly slice the tape only, to allow you to release the cardboard. **DO NOT** slice too deeply as there is risk of cutting the furniture inside.

3. Bubble wrap

The bubble wrap rests on top of the furniture, so you must be very careful with this layer. Remove the bubble wrap by tearing with your hands only. **DO NOT** use a knife on this layer, as you are likely to cut too deep and damage your furniture. You are responsible for disposing of all packaging after removal.

